



Wood Beams & Baffles

Wood beams and baffles create unique ceiling designs and can be used to complement additional ceiling and walls products to provide depth, separation, and visual interest for a comprehensive visual.

Features & Benefits

- Beam Sizes:
 - Veneer: Widths from 2" to 8", Length up to 120", Depth up to 12"
- Baffle Sizes:
 - Solid Wood: Widths from 3/4" to 1-3/4", Length up to 120", Depth up to 6" (Availability varies by Species)
 - Veneer: Widths from 1"-1-3/4", Length up to 120", Depth up to 12"
- Available in a variety of standard and custom configurations to complement design elements and installation requirements
- Installation methods for both ceiling and wall applications
- Wide array of solid wood and veneer species, cuts, and matches
- Additional custom materials, staining, sheening, and color matching are also available upon request
- Manufactured with sustainable wood materials
- Comprised of low-emitting materials and components
- FSC® available upon request

Attributes



TESTED PER ASTM E84
AND CAN/ULC-S102



CUSTOMIZATION
AVAILABLE

LEED® v4

RECYCLED CONTENT	up to 75%
✓ EQ: Low-Emitting Materials (EQc) ¹	
✓ MR: Regional Materials (MR Credits) ²	
✓ MR: EPD (MRC2)	
✓ MR: Raw Materials Sourcing (MRC4) ³	

¹CertainTeed Wood Ceiling and Wall products meet General Emissions Evaluation per the CDPH standard; v1.2 2017

²200% credit if project with 100 miles of manufacturing site

³Ask about FSC® availability (FSC-C151918)
LEED® is a registered trademark of the U.S. Green Building Council.

CERTIFICATIONS & PRODUCT DECLARATIONS



FSC® AVAILABLE
ON REQUEST

LOW
VOC

LOW-EMITTING
MATERIALS / LOW VOC
(CDPH/EHLB/
STANDARD METHOD
VERSION 1.2, 2017)



EPD AVAILABLE

Wood Beams & Baffles

Colors & Finishes

A wide variety of solid wood and veneer species, cuts, and matches are available. Additional custom materials and color matching are also available upon request. Actual shades or grains may vary; request a sample for more accurate finish portrayal. Solid wood and veneer species are shown with a clear finish and top coat. The three character species code is followed by the single character finish code.

For example: Solid Poplar (WPL) in an Oat finish (D) is WPLD. Species below shown with clear finish (O).

Standard Solid Woods

Hardwoods



Poplar
(WPL0)

Softwoods



Hemlock Mixed Grain
(WHM0)



Hemlock Vertical
Grain (WHV0)

Standard Veneers

Plain Slice Veneers



Plain Slice Natural
Cherry (VPC0)



Plain Slice Maple
(VMP0)



Plain Slice Red Oak
(VPR0)

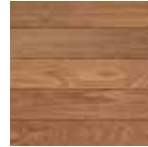

Plain Slice White Oak
(VPO0)



Plain Slice Walnut
(VPW0)

Quartered and Rift Cut Veneers



Quartered Cherry
(VQC0)

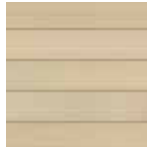

Quartered Maple
(VQM0)



Rift Cut Red Oak
(VRR0)



Rift Cut White Oak
(VRO0)



Quartered Walnut
(VQW0)

Reconstituted Quartered Veneers*



Quartered Cherry
(RRC0)

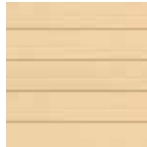

Quartered Maple
(RMC0)



Quartered Blonde
(RQB0)



Quartered Oak
(RRO0)



Quartered Walnut
(RWN0)

*Engineered from natural wood to deliver a uniform appearance across an installation

Stains and Finishes

Standard Stains and Finishes^{1,2}



Clear (O)



Patina (A)

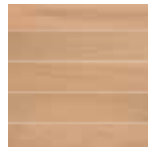

Sepia (J)



Hazel (L)

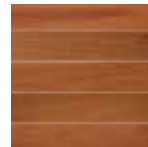

Oat (D)



Auburn (H)

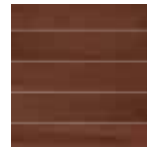

Merlot (I)

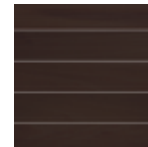

Coffee (C)



Opaque White (S)

¹Standard Solid Wood Stains and Finishes shown on Poplar (WPL)

²Standard Veneer Stains and Finishes: Plain Slice Maple Patina (VMPA), Plain Slice Cherry Auburn (VPCH), Plain Slice Cherry Merlot (VPCI), and Plain Slice Walnut Coffee (VPWC)



Additional veneer species, stains, color matching and finishes are available upon request. Please see catalog for more options or contact your local sales representative to get started.

Wood Beams & Baffles

Beam Construction

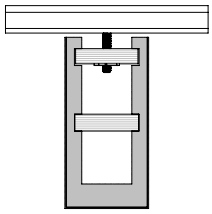

Direct Mount Fabricated Beam
Adjustable Attachment
(OE, OC, CE)

Beam Configuration Options

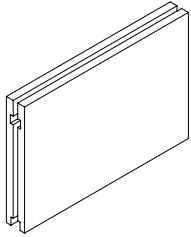

Open Ends (OE)
(Interior Beam;
Two Splice Attachments)

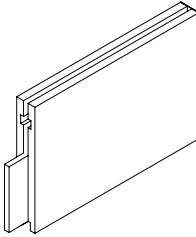

Open End & Closed End (OC)
(Single Splice Attachment;
Splice Plate Shown)

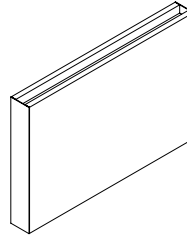

Closed Ends (CE)
(Independent Beam)

Beam Dimensions

	veneER
Height	up to 12"
Width	2"-8"
Length	up to 10'

Beam Installation

Fabricated Veneer Beam
Direct Mount (OE, OC, CE)

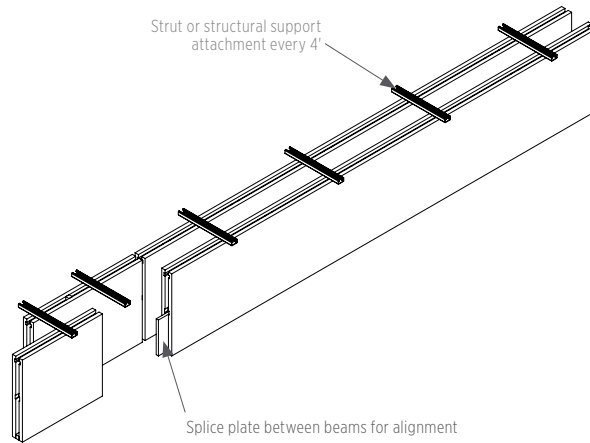

Baffle Construction

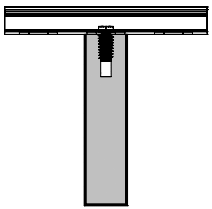

Veneer
Fixed Attachment Points (SD)

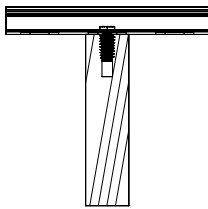

Direct Mount, Solid Wood
Fixed Attachment Points (SD)

Baffle Dimensions

	veneER	SOLID WOOD*
Height	up to 12"	up to 6"
Width	1"-1-3/4"	3/4"-1-3/4"
Length	up to 10'	up to 10'

* Width, Height and Length Combinations vary by Species

Baffle Installation

Solid Wood and Veneer Baffles
Fixed Attachment Points (SD)

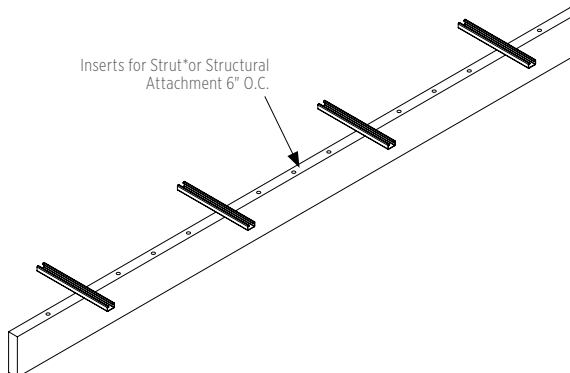

*Attachment hardware provided with order;
Strut or structure by others



Photo © Eric Laignel / LinkedIn Office Lobby, New York, NY

Physical Data

MATERIAL

Beams: Fire-retardant composite wood and Hardwood Plywood.

Baffles: Fire-retardant composite wood or solid wood

WEIGHT

Varies by Configuration and Material, 2 - 16 lbs./in. ft.

FLAME SPREAD/SMOKE DEV.

Per ASTM E84 — CAN/ULC S102

Veneered Beams and Baffles:

Flame Spread: 25 or less

Smoke Developed: 50 or less

(Class A per ASTM E1264)

Solid Wood Baffles:

ASTM E84 and CAN/ULC-S102

Flame Spread: 200 or less

Smoke Developed: 150 or less

(Class C per ASTM E1264)

SEISMIC INSTALLATION

Consult local code officials for jurisdictional requirements. Beams and Baffles can be positively attached to structure.

APPLICATION CONSIDERATIONS

Wood products must be acclimatized for 72 hours prior to installation. Maintain relative humidity between 25% and 55% and temperature between 50°F and 80°F (10°C and 26°C) for the life of the product.

Wood is a natural material with varying grain and color characteristics. Characteristics may vary from panel to panel. For a more uniform appearance, consider reconstituted veneer options.

VISUAL CONSIDERATIONS

Surface Finish: clear or tinted topcoat 20 GU @ 60° (20% sheen); stains and colors available.

WARRANTY

Full warranty information can be found at certainteed.ca/warranty.



CertainTeed

CEILINGS • GYPSUM • INSULATION • ROOFING • SIDING • TRIM

2424 Lakeshore Rd. West, Mississauga, ON L5J1K4 800-233-8990 certainteed.ca